

DERBY CITY COUNCIL

TOWN AND COUNTRY PLANNING GENERAL DEVELOPMENT ORDER 1988

Direction under Article 4

LITTLE CHESTER CONSERVATION AREA DERBY

WHEREAS the Derby City Council ("the Council") being the appropriate local planning authority within the meaning of Article 4 of the Town and Country Planning General Development Order 1988 ("the Order") are of the opinion that development of the description set out in the first schedule should not be carried out within the conservation area at those properties ("the Properties") within the area shown edged red on the plan annexed hereto and detailed in the second schedule unless permission therefor is granted on an application made under the Town and Country Planning General Development Order 1988 AND WHEREAS the Council is further of the opinion that development of this description would constitute a threat to the amenities of its area and that the provisions of paragraph 4 of the article 5 of the Order should apply to this direction

NOW THEREFORE the Council in pursuance of the powers conferred on it by the said Article 4 HEREBY DIRECT that the permission granted by article 3 of the Town and Country Planning General Development Order 1988 shall not apply to development of the Properties of the description set out in the First Schedule hereto

THIS DIRECTION is made in pursuance of the provisions of paragraph 4 of article 5 of the Order and shall remain in force until 29 April 1993 (being six months from the date of this direction) and will then expire unless it has been ^{disallowed or} approved by the Secretary of State for the Environment before that date

FIRST SCHEDULE

1. The alteration(s) to doors, windows, roof materials of a dwelling house ^{development} being comprised within Part 1 Classes A, B, and C

or the rendering of external brickwork on any elevation of a dwelling house fronting a highway

referred to in the Second Schedule to the Order and not being development comprised within any other Class

2. The painting ~~or rendering~~ of external brickwork on any elevation of a dwelling house fronting a highway being development comprised within Part 2 Class C referred to in the Second Schedule to the Order and not being development comprised within any other Class

SECOND SCHEDULE

✓ Kirk Street : 1, 21
✓ Marcus Street : 1
✓ Mansfield Road : 169

THE COMMON SEAL of DERBY CITY)
COUNCIL was hereunto affixed)
in the presence of:-)

MAGDORE

City Secretary

Dated 29 October 1992

The Secretary of State for the Environment
hereby approves the foregoing direction
subject to the modifications shown in red
ink thereon.

RJS

Signed by authority
of the Secretary of
State

21 April 1993

A Regional Controller
in the Department of
the Environment.

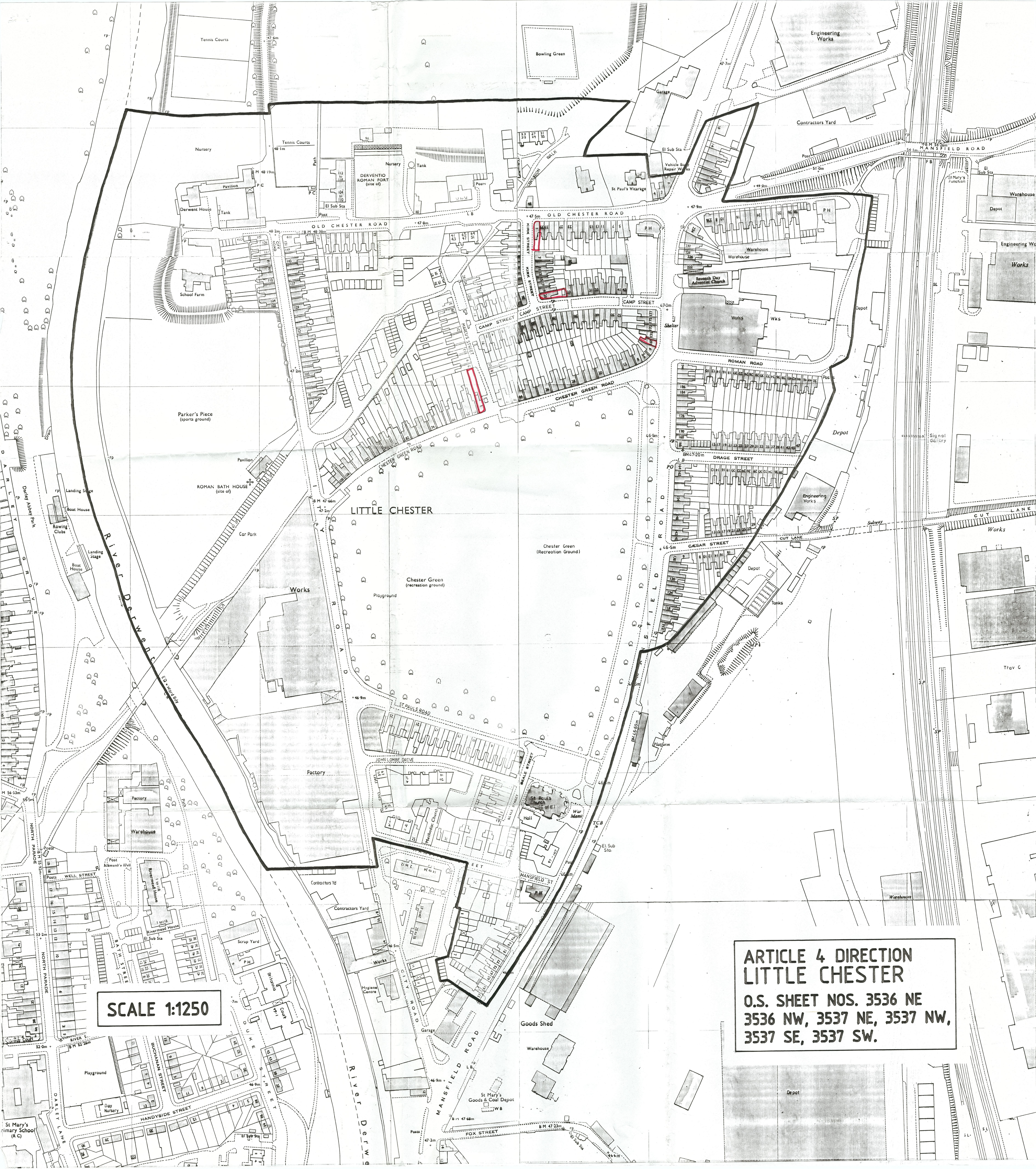

SCALE 1:1250

ARTICLE 4 DIRECTION
LITTLE CHESTER
O.S. SHEET NOS. 3536 NE
3536 NW, 3537 NE, 3537 NW,
3537 SE, 3537 SW.