

Mr John Fleming  
J H Powell & Co  
DX11515  
DERBY 1

Your ref:  
Our ref: SWT/147  
Date: 29 August 2008  
Contact: Stephen Teasdale  
E-mail: [stephen.teasdale@derby.gov.uk](mailto:stephen.teasdale@derby.gov.uk)  
Telephone: 01332 255453  
Minicom: 01332 256666  
Fax: 01332 255834

Dear Mr Fleming

**CATHEDRAL CHAMBERS CAR PARK, AMEN ALLEY, DERBY:  
SECTION 31(6) ACT 1980:**

Please find enclosed receipted duplicate copy of the section 31(6) notice as requested.

A copy has been forwarded to our rights of way officer for their records and for deposit.

Yours sincerely

Stephen Teasdale  
Solicitor

Copy:  
Ray Brown: Regeneration and Community Services (Roman House)

**NOTICE**

**(pursuant to Section 31(6) of the Highways Act 1980)**

**To: Stuart Leslie Esq.,  
Chief Legal Officer,  
Derby City Council,  
PO Box 6292,  
The Council House,  
Corporation Street,  
Derby  
DE1 2ZL**

I **JOHN MASON FLEMING** partner of **J H POWELL & CO** solicitors of Cathedral Chambers, Amen Alley, Derby DE1 3GT the owner of Cathedral Chambers Amen Alley Derby DE1 3GT and adjoining car park shown coloured red on the attached Plan ("Cathedral Chambers Car Park") **GIVE NOTICE** pursuant to Section 31(6) of the Highways Act 1980 that no ways over across or upon Cathedral Chambers Car Park shown coloured red on the accompanying Plan have been dedicated as Highways or Footpaths.

**DATED** this

20<sup>th</sup>

day of

August

2008

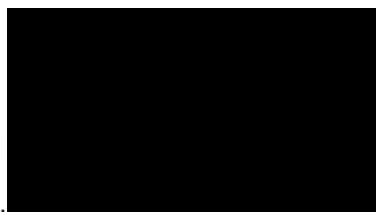

.....  
**JOHN MASON FLEMING**  
Partner of J H Powell & Co

Land Registry

Official Copy

This copy may not be the same size as the original.

REDUCED PHOTOGRAPHIC COPY

DY3:135  
Grave Yard

H.M. LAND REGISTRY  
TITLE No. 100/110/1  
PHOTOGRAPHIC COPY  
(liable to distortion in scale)  
of PLAN to *Transfers*  
dated 4-5-1474



*Sonough Secretary*

*Solution to the Transfers.*

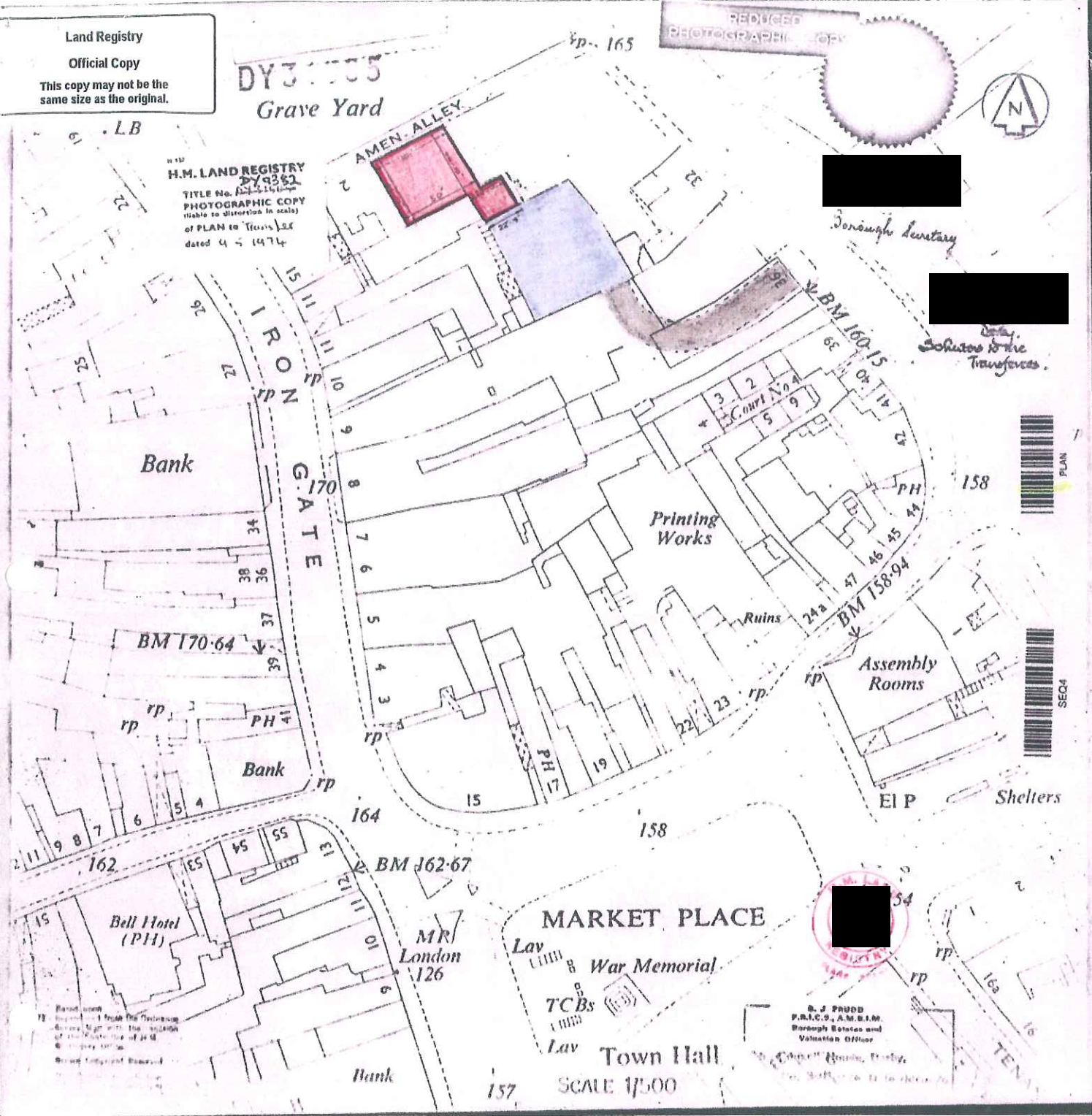

20/08/2008

**NOTICE**

**(pursuant to Section 31(6) of the Highways Act 1980)**

**To: Stuart Leslie Esq.,  
Chief Legal Officer,  
Derby City Council,  
PO Box 6292,  
The Council House,  
Corporation Street,  
Derby  
DE1 2ZL**

**I JOHN MASON FLEMING** partner of **J H POWELL & CO** solicitors of Cathedral Chambers, Amen Alley, Derby DE1 3GT the owner of Cathedral Chambers Amen Alley Derby DE1 3GT and adjoining car park shown coloured red on the attached Plan ("Cathedral Chambers Car Park") **GIVE NOTICE** pursuant to Section 31(6) of the Highways Act 1980 that no ways over across or upon Cathedral Chambers Car Park shown coloured red on the accompanying Plan have been dedicated as Highways or Footpaths.

DATED this

20<sup>th</sup>

day of

August

2008

.....  
**JOHN MASON FLEMING**  
Partner of J H Powell & Co

**Received** the original notice of which the above is a true copy  
this 22<sup>nd</sup> day of August 2008.

..... for Derby City Council

Land Registry

Official Copy

This copy may not be the same size as the original.

DY3155  
Grave Yard

H.M. LAND REGISTRY  
TITLE No. DY3155  
PHOTOGRAPHIC COPY  
(liable to distortion in scale)  
of PLAN to TOWN 125  
dated 4 4 1974



AMEN ALLEY

IRON GATE

Bank

Printing Works

Sonough Lantry

Solutions to the Transfers

BM 170-64

Assembly Rooms

Bank

Ruins

Shelters

Bell Hotel (PH)

MARKET PLACE

MR London 126

War Memorial

TCBs

Town Hall

R. J. BRUND  
P.R.I.C.S., A.M.B.I.M.  
Borough Surveyor and  
Valuation Officer

SCALE 1/100



20/08/2008

22nd August 2008